

4

3

2

1

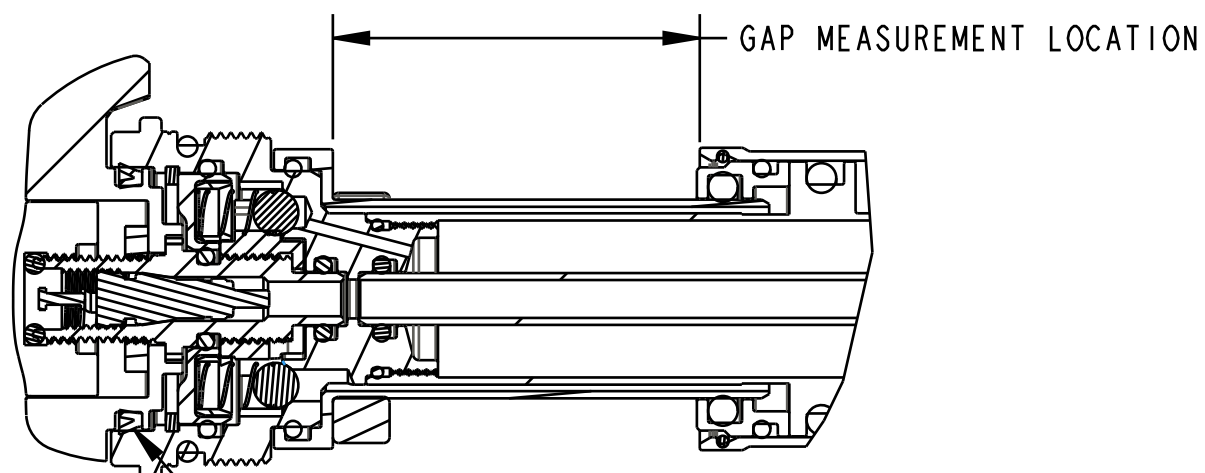
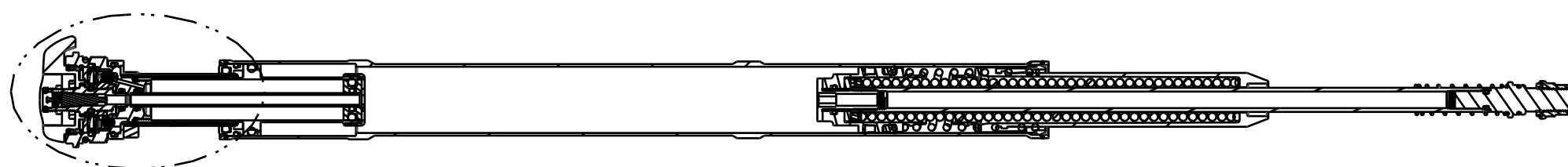

IMPORTANT:
NOTE ORIENTATION
OF U-CUP SEAL

REFERENCE ONLY
(FOR INSTALLATION
INTO FORK)

TORQUE:
50±5 IN.LB.

234-04-593
Neg Plate, TALAS 5

OIL:
LIGHTLY COAT OD OF SPRINGS
WITH FLOAT FLUID

038-01-060

Retaining Ring: Wire [0.950 OD x 0.040 CS]

241-01-002

Fastener, Custom: Crush Washer, Plastic, R_RL_RLC

241-00-005

Fastener, Custom: Nut, Bottom, R_RL_RLC

AIR SHAFT ASSEMBLY

234-04-865
CARTRIDGE TUBE

REFERENCE ONLY
(FOR INSTALLATION
INTO FORK)

TORQUE:
220±5 IN.LB.

GREASE:
THIN LAYER
OF SLICK HONEY

TORQUE:
40±5 IN.LB.

TORQUE:
25±5 IN.LB.

10cc FLOAT FLUID

820-05-355-KIT
TOPCAP ASSEMBLY

029-08-060

Seals: O-Ring [6.0mm ID x 1.5mm CS] Metric, N-70, Static

010-00-050

Air Valve Parts: Tank Valve [5/16-32] w/O-ring Boss

GREASE:
THIN LAYER
OF SLICK HONEY

036-01-043

Seals: U-Cup, Shore 70A, 2013 Fit-CTD and CTD-ADJ

234-04-423
LEVER

241-00-009

NUT, 5/16-32

029-03-008

O-Ring (-008) [.070 C.S. X .176 ID]

234-04-424
Air Cap, TALAS 5

PROPRIETARY
THIS DOCUMENT CONTAINS CONFIDENTIAL, PROPRIETARY INFORMATION
THAT IS FOX PROPERTY. DO NOT DISCLOSE TO OR DUPLICATE
FOR OTHERS EXCEPT AS AUTHORIZED BY FOX.

FOX FOX Factory, Inc. Ph 831-768-1100
130 Hangar Way, Watsonville, CA 95076 USA Fax 831-768-9312

TITLE
**2016 34mm TALAS 5, No XV Sleeve
Cartridge Assembly, Complete**

SIZE DWG. NO.
C

PLOT SCALE 0.60:1

SHEET 1 OF 1

4

3

2

ProE ASSEM