

IMPORTANT:
ALIGN SOLENOID AND RETAINER PLATE
TO EYELET AS SHOWN $\pm 30^\circ$

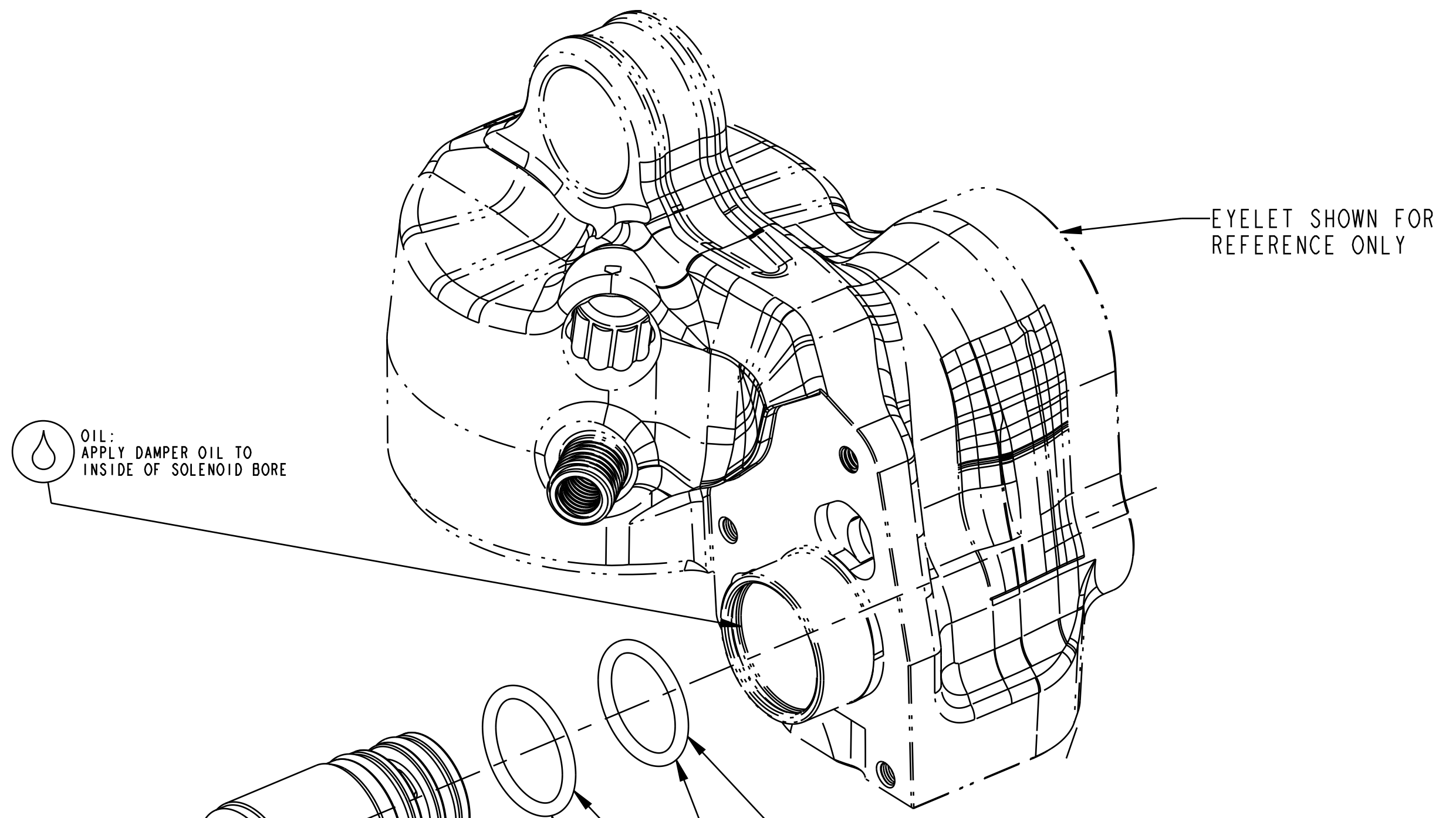

EYELET SHOWN FOR
REFERENCE ONLY

OIL:
APPLY DAMPER OIL TO
INSIDE OF SOLENOID BORE

IMPORTANT:
ALIGN OPEN ENDS OF RETAINING RING TO BE
OPPOSITE OF RETAINING PLATE OPENING $\pm 45^\circ$

IMPORTANT:
ENSURE WIRE RING FULLY
SEATED FOR FULL 360°

GREASE:
THIN LAYER
OF SLICK HONEY

Seals: O-Ring [12.0MM ID x 1.5MM CS] Metric, N-70, Static

Seals: O-Ring [12.5mm ID X 1.5mm CS] Metric, N-70, Static

NOTE:
REMOVE AND DISCARD ANY O-RINGS
FROM SOLENOID IF PRESENT

820-09-130-KIT
Live Valve Neo, Solenoid Assembly, High Flow, G2, FEMA

210-03-397
Solenoid Retainer Plate, 2024 Live Valve Neo, Shock

038-01-074
Retaining Ring: Wire, Solenoid End Cap, 2017 LIVE

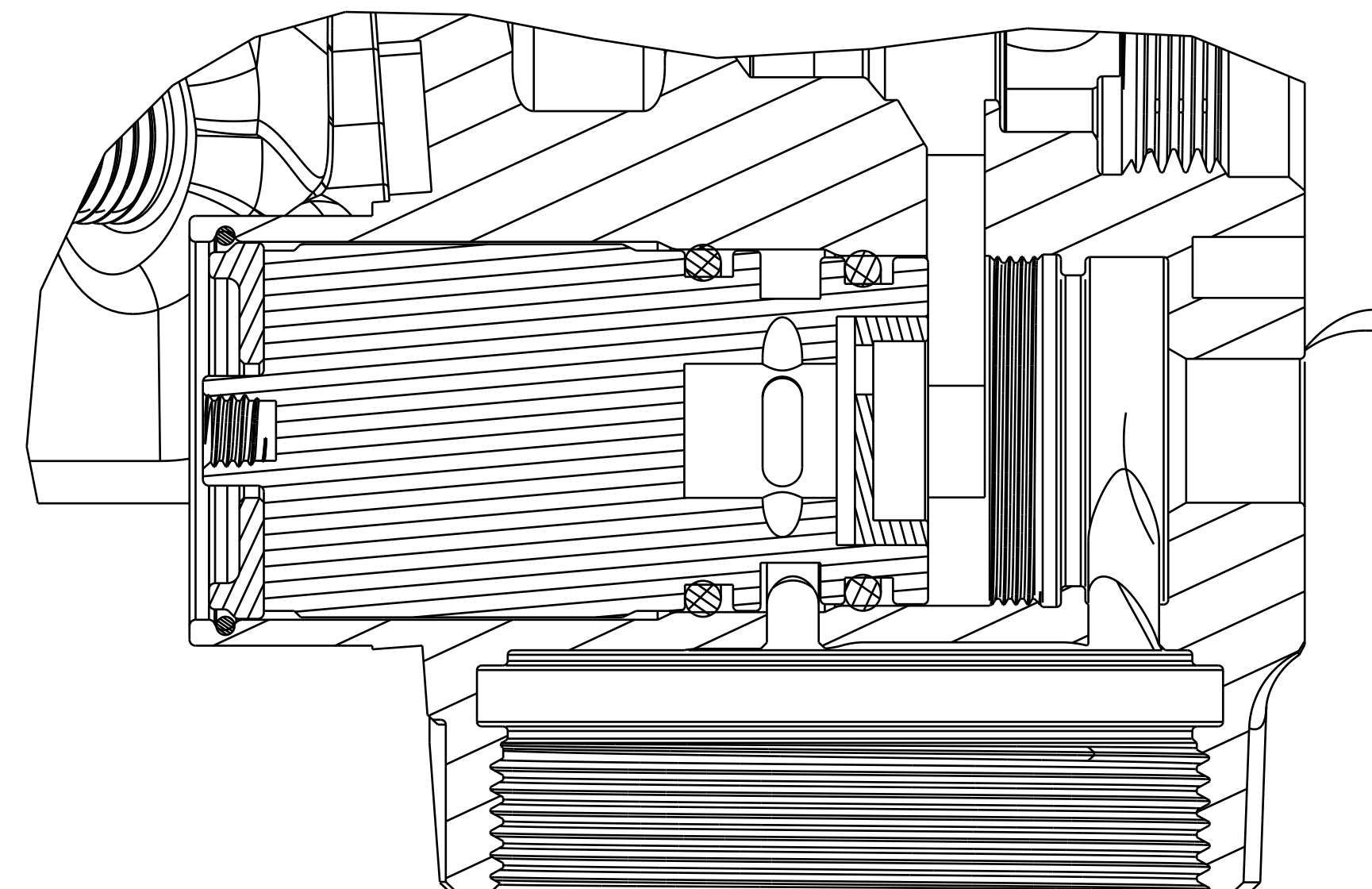

SECTION A-A
SCALE 4:1

PROPRIETARY
THIS DOCUMENT CONTAINS CONFIDENTIAL, PROPRIETARY INFORMATION
THAT IS FOR PROPERTY. DO NOT DISCLOSE TO OR DUPLICATE
FOR OTHERS EXCEPT AS AUTHORIZED BY FOX.

FOX Factory, Inc. 130 Hangar Way, Watsonville, CA 95076 USA Ph 831-768-1100 Fax 831-768-9312	
TITLE Eyelet Sub Assy: Live Valve Solenoid, 2025 FLOAT X Live Valve Neo, Shock	
SIZE DWG. NO. D 808-17-529-KIT	PLOT SCALE 2:1 SHEET 1 OF 1