

4

3

2

1

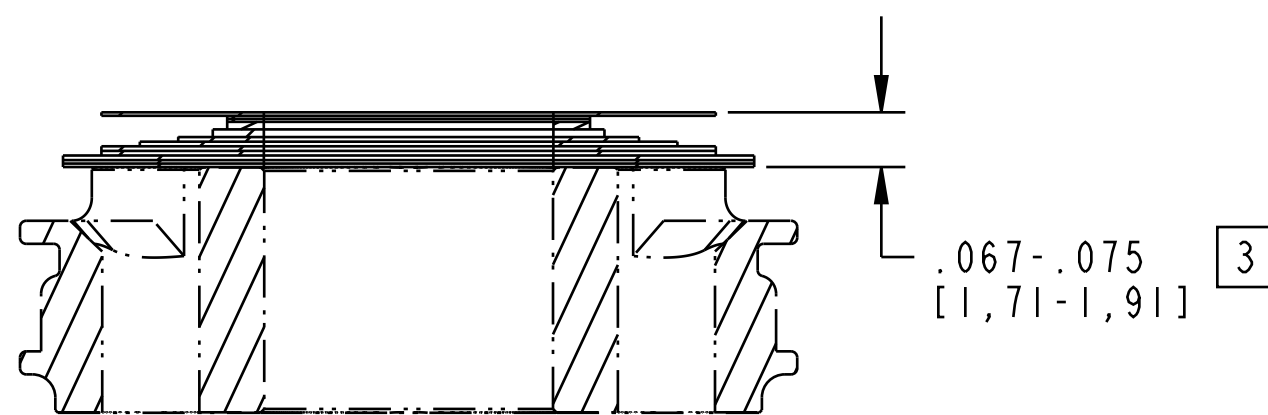

Valve: [.800 OD X .377 ID X .0045 TH]

Valve: Metric [12.0 mm OD X 9.58mm ID X 0.10mm TH]

Valve: Metric [12.0 mm OD X 9.58mm ID X 0.25mm TH]

Valve: [.510 OD X .377 ID X .010 TH]

Valve: [.600 OD X .377 ID X .006 TH]

Valve: [.700 OD X .377 ID X .006 TH]

Valve: [.800 OD X .377 ID X .006 TH]

Valve: [.900 OD X .377 ID X .006 TH]

Valve: [.900 OD X .377 ID X .0045 TH]

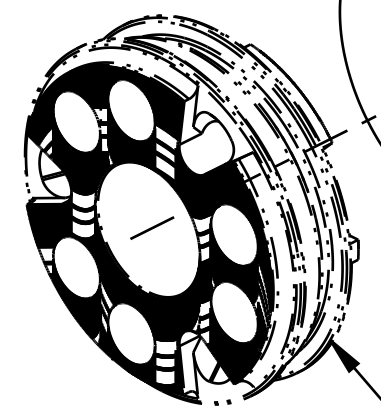

Valve: [.900 OD X .377 ID X .0045 TH]

Valve: [.800 OD X .377 ID X .006 TH]

IMPORTANT:
DO NOT REMOVE

2

Valve: Metric [12.0 mm OD X 9.58mm ID X 0.10mm TH]

IMPORTANT:
DO NOT REMOVE

MANUFACTURING NOTES:

1 MAIN PISTON ASSEMBLY SHOWN FOR ORIENTATION PURPOSES. NOTE PROPER ORIENTATION OF PISTON--SEE VALVING ASSEMBLY DRAWING FOR DETAILS. IMAGE SHOWN MAY NOT REPRESENT ACTUAL PART GEOMETRY.

2 INDICATED SPACERS MAY BE ADDED OR REMOVED TO ADJUST NUMBER OF REBOUND CLICKS.

3 DIMENSION APPLIES TO VALVE STACK AS SHOWN.

DESIGN ENGINEERING AND PRODUCT PERFORMANCE NOTES:

4. REBOUND VALVE STACK NOMINAL MINIMUM THICKNESS (NMT): .058 [1,47]

- PROPRIETARY -
THIS DOCUMENT CONTAINS CONFIDENTIAL, PROPRIETARY INFORMATION THAT IS FOX PROPERTY. DO NOT DISCLOSE TO OR DUPLICATE FOR OTHERS EXCEPT AS AUTHORIZED BY FOX.

		FOX Factory, Inc.	Ph 831-768-1100 Fax 831-768-9312
TITLE		130 Hangar Way, Watsonville, CA 95076 USA	
Valve Stack Assy: 2025 FLOAT X & DHX, RL20, Rebound Linear, .058 NMT			
SIZE	DWG. NO.	805-05-720-KIT	
C	PLOT SCALE	2:1	SHEET 1 OF 1

4

3

2

1

ProE ASSEM