

210-03-360  
Knob, Rebound, 2022 FLOAT X, Red

010-01-000

(010-01-000)

(039-00-699)

(010-01-000)

039-00-699  
Spring: Detent, Rebound, 2022 FLOAT X

010-01-000  
Ball [Ø 0.1250] Steel

GREASE:  
HEAVY LEVEL  
OF ULTRAPLEX LT2

GREASE:  
HEAVY LEVEL  
OF ULTRAPLEX LT2

808-17-529-KIT  
Eyelet Sub Assy: Live Valve Solenoid, 2025 Live Valve Neo, Shock, FLOAT

010-00-057  
Air Valve Parts: Cap, Air Valve [L.305-32], Black, 6061

010-00-005  
Air Valve Parts: Core, Eaton, Low pressure

EYELET

GREASE:  
THIN LAYER  
OF SLICK HONEY

Seals: O-Ring [11.0mm ID X 1.5mm CS] Metric, N-70, Static

Seals: O-Ring [(-032) .070 C.S. X 1.864 ID] Standard N674-70, Dynamic

GREASE:  
THIN LAYER  
OF SLICK HONEY

.010-.040 \*  
[0.26-1.01]  
VALVE CORE DEPTH  
100% INSPECT VIA  
DIGITAL GAGE

O-Ring (-025) [0.070 C.S. X 1.176 ID]

808-17-527-KIT  
Eyelet Sub Assy: Base Valve & LSC Adjust, 2024 Live Valve Neo, Shock, FLOAT

808-17-528-KIT  
Eyelet Sub Assy: Firm Mode Adjust, 2024 Live Valve Neo, Shock, FLOAT

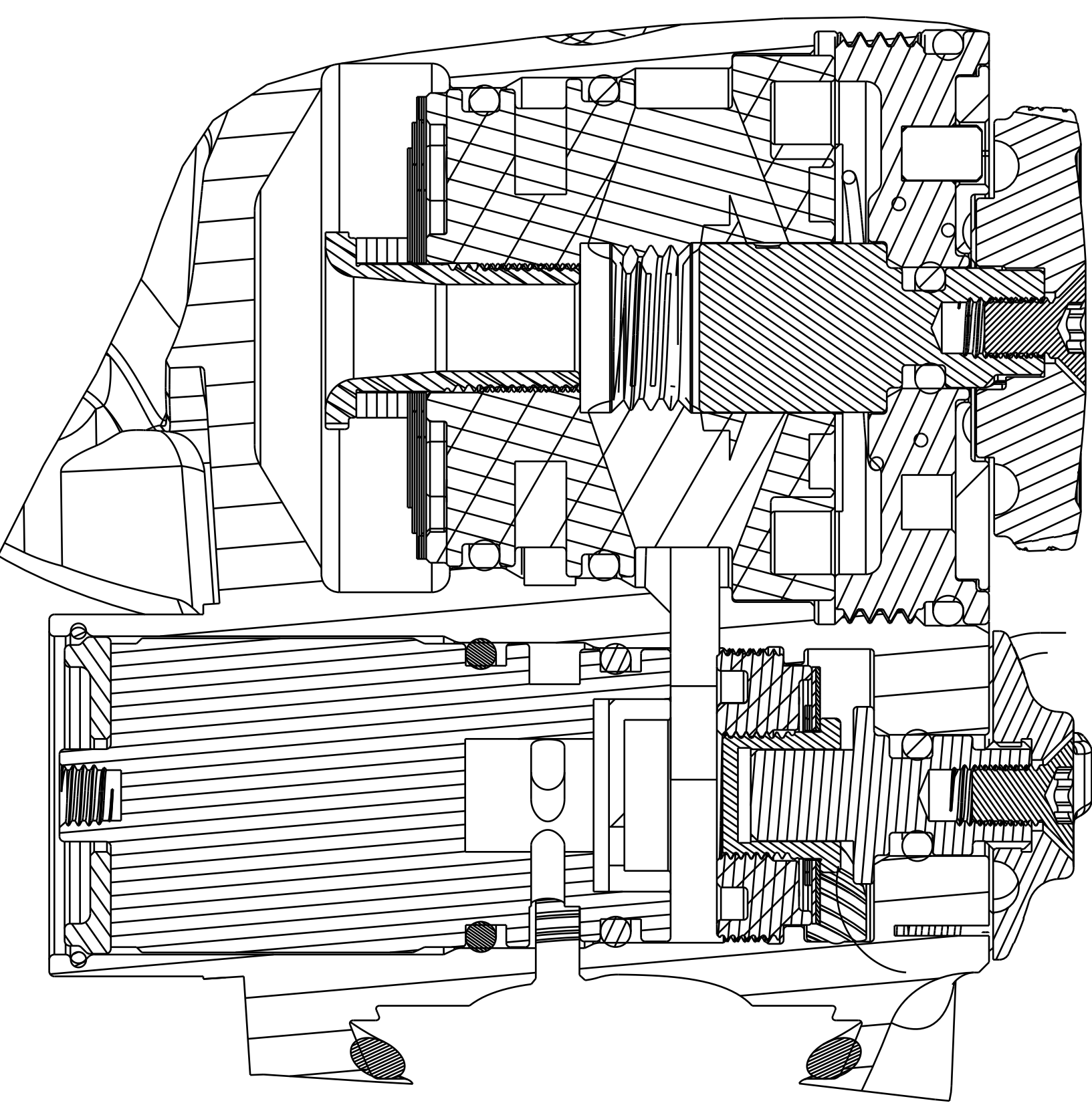

SECTION A-A  
SCALE 4:1

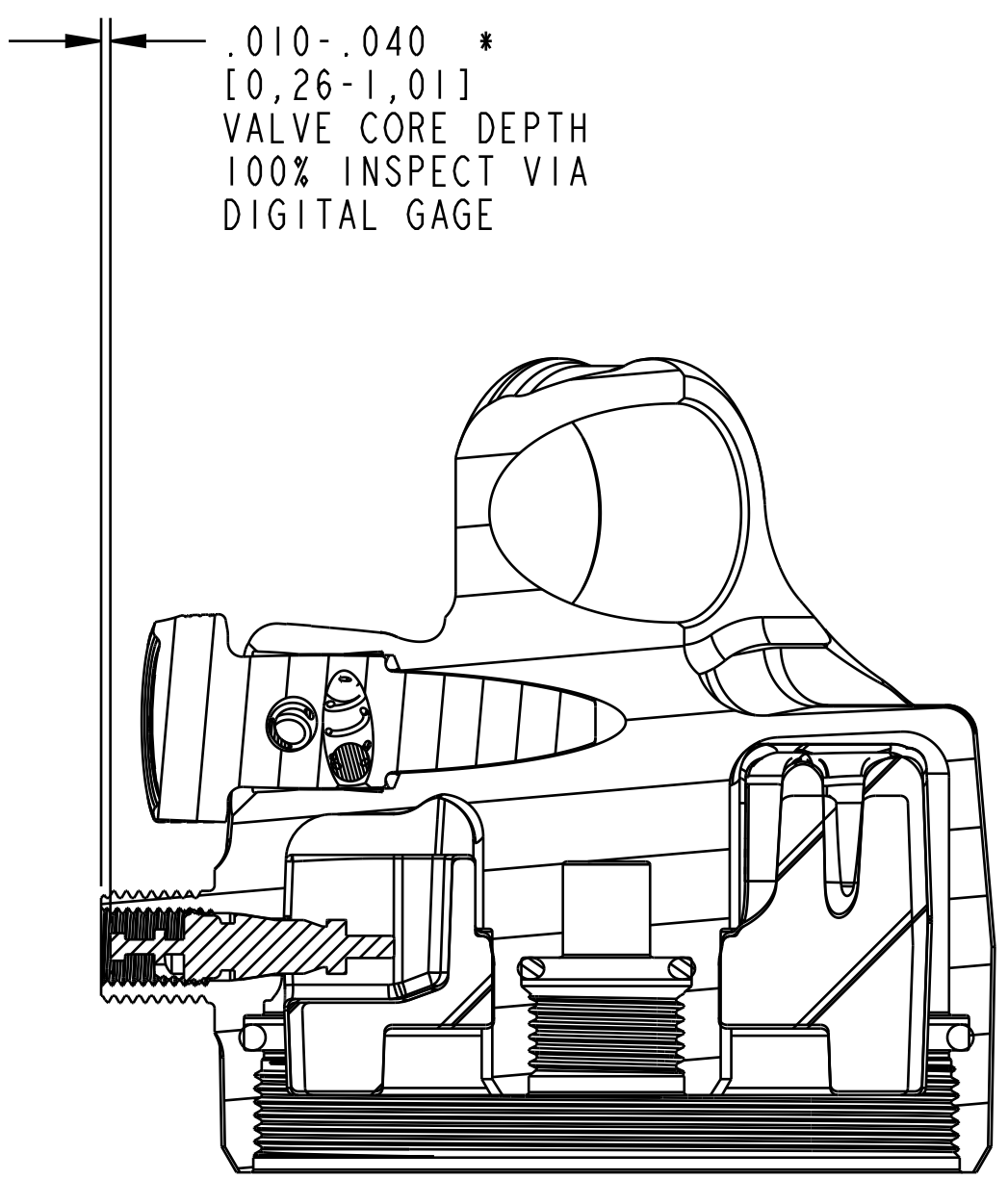

SECTION B-B

PROPRIETARY  
THIS DOCUMENT CONTAINS CONFIDENTIAL, PROPRIETARY INFORMATION  
THAT IS FOR PROPERTY. DO NOT DISCLOSE TO OR DUPLICATE  
FOR OTHERS EXCEPT AS AUTHORIZED BY FOX.

**FOX Factory, Inc.**  
130 Hangar Way, Watsonville, CA 95076 USA  
Ph 831-768-1100  
Fax 831-768-9312

TITLE  
**Eyelet, 2025 FLOAT X  
Live Valve Neo, Shock**

SIZE DWG. NO.  
D

PLOT SCALE 2:1

SHEET 1 OF 1