

4

3

2

1

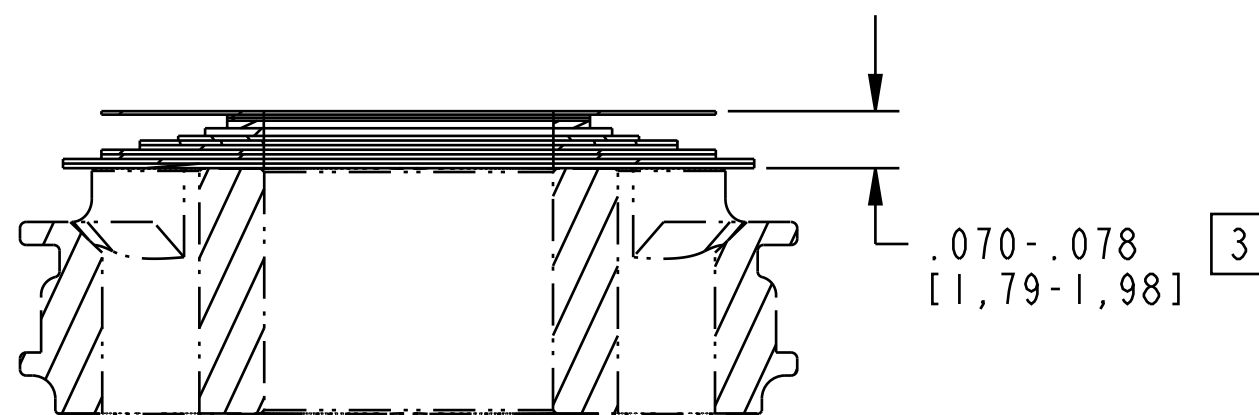

Valve: [.800 OD X .377 ID X .0045 TH]

Valve: Metric [12.0 mm OD X 9.58mm ID X 0.10mm TH]

Valve: Metric [12.0 mm OD X 9.58mm ID X 0.25mm TH]

Valve: [.530 OD X .377 ID X .010 TH]

Valve: [.600 OD X .377 ID X .006 TH]

Valve: [.700 OD X .377 ID X .006 TH]

Valve: [.800 OD X .377 ID X .006 TH]

Valve: [.900 OD X .377 ID X .006 TH]

Valve: Metric [12.0 mm OD X 9.58mm ID X 0.10mm TH]

Valve: [.700 OD X .377 ID X .006 TH]

Valve: [.800 OD X .377 ID X .006 TH]

Valve: [.900 OD X .377 ID X .006 TH]

MAIN PISTON ASSY 1

IMPORTANT:
DO NOT
REMOVE

MANUFACTURING NOTES:

- 1 MAIN PISTON ASSEMBLY SHOWN FOR ORIENTATION PURPOSES. NOTE PROPER ORIENTATION OF PISTON--SEE VALVING ASSEMBLY DRAWING FOR DETAILS. IMAGE SHOWN MAY NOT REPRESENT ACTUAL PART GEOMETRY.
- 2 INDICATED SPACERS MAY BE ADDED OR REMOVED TO ADJUST NUMBER OF REBOUND CLICKS.
- 3 DIMENSION APPLIES TO VALVE STACK AS SHOWN.

DESIGN ENGINEERING AND PRODUCT PERFORMANCE NOTES:

4. REBOUND VALVE STACK NOMINAL MINIMUM THICKNESS (NMT): .061 [1,55]

- PROPRIETARY -
THIS DOCUMENT CONTAINS CONFIDENTIAL, PROPRIETARY INFORMATION
THAT IS FOX PROPERTY. DO NOT DISCLOSE TO OR DUPLICATE
FOR OTHERS EXCEPT AS AUTHORIZED BY FOX.

FOX FOX Factory, Inc. Ph 831-768-1100
130 Hangar Way, Watsonville, CA 95076 USA Fax 831-768-9312

TITLE
Valve Stack Assy: 2025 FLOAT X & DHX,
RL40, Rebound Linear, .061 NMT

SIZE DWG. NO. **C** 805-05-722-KIT

PLOT SCALE 2:1 SHEET 1 OF 1

4

3

2

1