

4

3

2

1

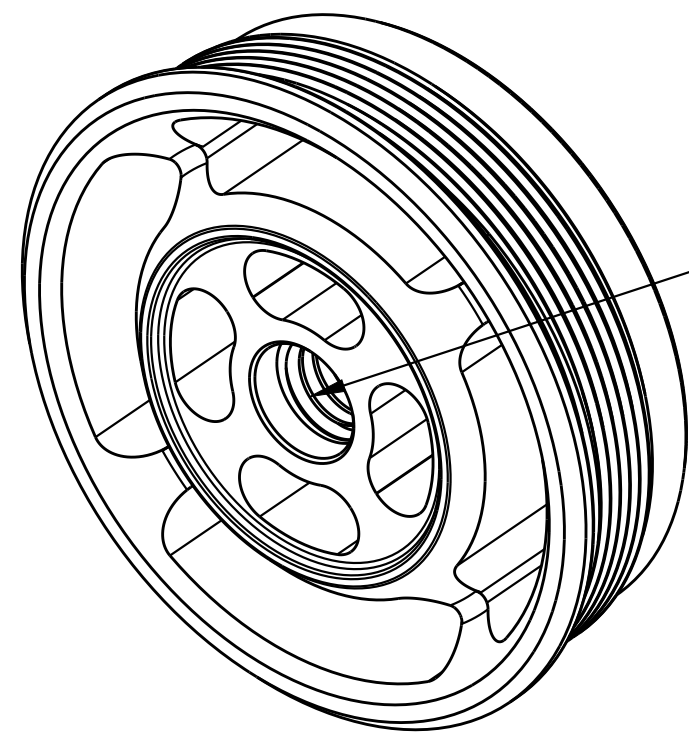

- IMPORTANT:
APPLY TO THREADS BELOW COUNTERBORE ONLY
NO LOCTITE ON VALVE SEALING SURFACES
- LOCTITE:
PRIMER 7649 TO ENTIRE PART
LET DRY 30 SECONDS
- LOCTITE:
RED 263
1-2 DROPS

Valve: Metric [22.23mm OD X 13.72mm ID X 0.25mm THK]

TORQUE:
55±5 IN.LB.

Piston, Damping, Compression, 2025 GRIP SL

TORQUE:
55±5 IN.LB.

Damping Adj Part: 2025, Coupler, Base Valve, GRIP SL

Spring: Conical, Rebound Check, 8.5 , 15.3 ID, 19.7 OD, 0.65 Wire

Fastener, Custom: Bolt, Base Valve, 2025 GRIP SL

TORQUE:
9±1 IN.LB.

SEE DETAIL Y

Damping Adj Part: Barrel, Adjuster, 2025 GRIP SL

820-03-711-KIT
Valve Stack Assy: 2025 GRIP SL, Compression Light, CL

GREASE:
THIN LAYER
OF SLICK HONEY

Seals: O-Ring [8mm ID X 1.5mm CS] Metric, N-70, Static

O-Ring (-010) [1.070 C.S. X .239 ID]

GREASE:
THIN LAYER
OF SLICK HONEY

Damping Adj Part: Hat Preload Comp, 2025 GRIP SL

Piston: Floating: 24mm Bore, 2025 GRIP SL

Fastener Standard (Metric): PIN SS 2 X 12

IFP BODY

Seals: O-Ring [20.0mm ID x 2.0mm CS] Metric, N-70, Static

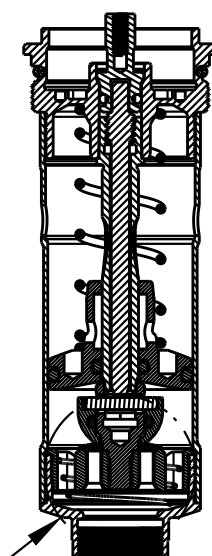

SEE DETAIL Z

SECTION A-A

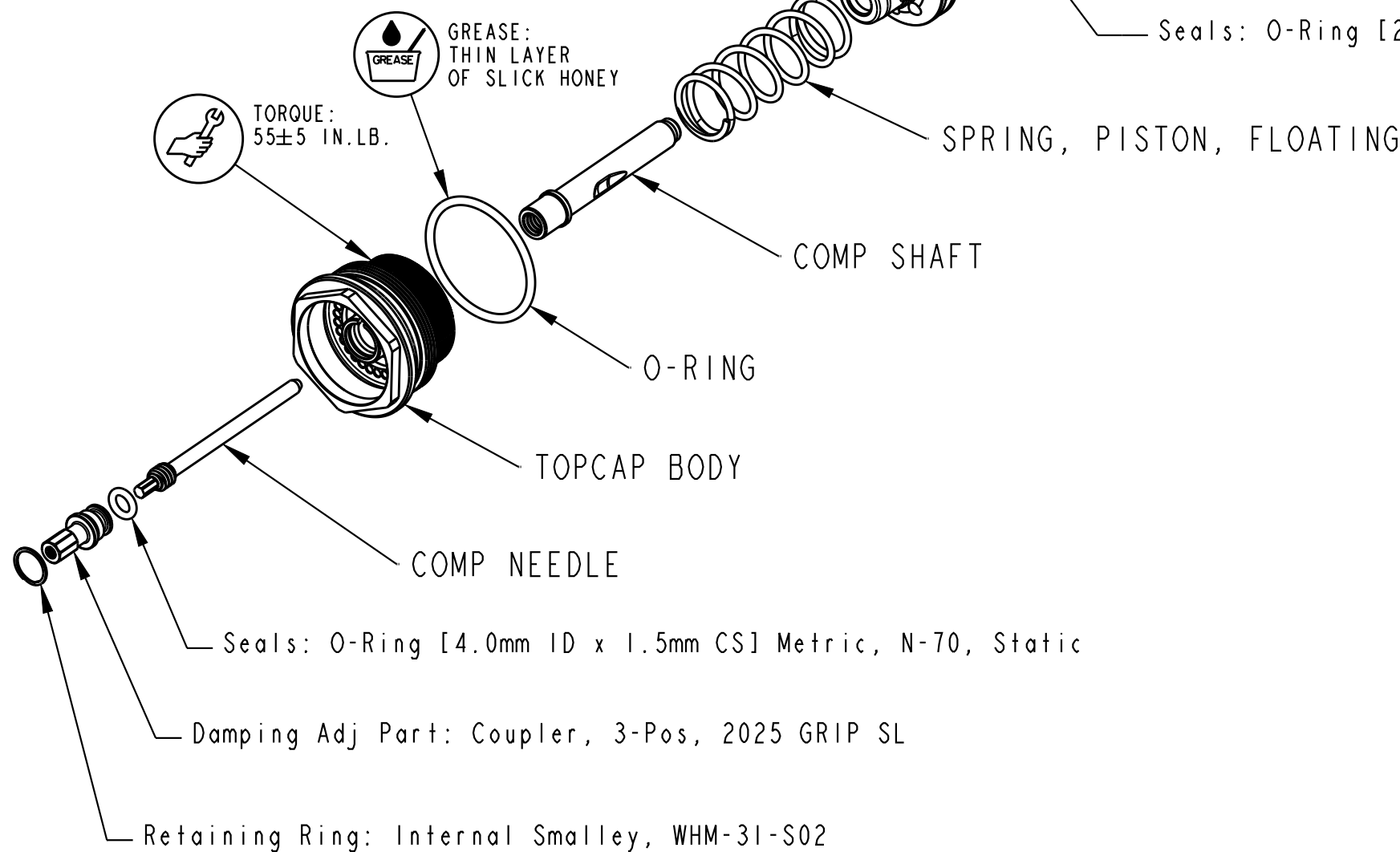

TORQUE:
55±5 IN.LB.

GREASE:
THIN LAYER
OF SLICK HONEY

SPRING, PISTON, FLOATING

COMP SHAFT

O-RING

TOPCAP BODY

COMP NEEDLE

Seals: O-Ring [4.0mm ID x 1.5mm CS] Metric, N-70, Static

Damping Adj Part: Coupler, 3-Pos, 2025 GRIP SL

Retaining Ring: Internal Smalley, WHM-31-S02

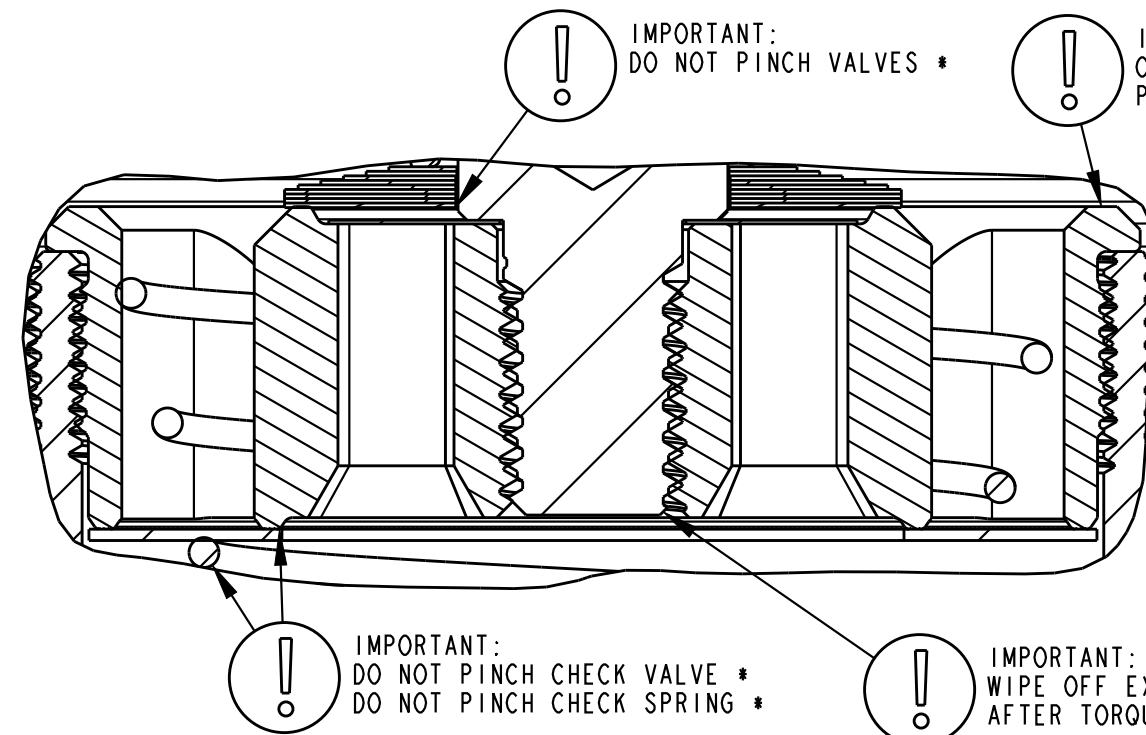

IMPORTANT:
DO NOT PINCH VALVES *

IMPORTANT:
ORIENTATION OF PISTON IS CRITICAL
PISTON FLANGE TOWARDS TOPCAP

IMPORTANT:
DO NOT PINCH CHECK VALVE *
DO NOT PINCH CHECK SPRING *

IMPORTANT:
WIPE OFF EXCESS LOCTITE
AFTER TORQUE

DETAIL Z
SCALE 6:1

- PROPRIETARY -
THIS DOCUMENT CONTAINS CONFIDENTIAL, PROPRIETARY INFORMATION
THAT IS FOX PROPERTY. DO NOT DISCLOSE TO OR DUPLICATE
FOR OTHERS EXCEPT AS AUTHORIZED BY FOX.

		FOX Factory, Inc.		Ph 831-768-1100
		130 Hangar Way, Watsonville, CA 95076 USA		Fax 831-768-9312
TITLE		2025 32 TC, GRIP SL, Topcap Assy, 3 Pos Adj		
SIZE	DWG. NO.	820-05-742-KIT		
C				
PLOT SCALE		1:1		SHEET 1 OF 1

4

3

2

ProE ASSEM