

4

3

2

1

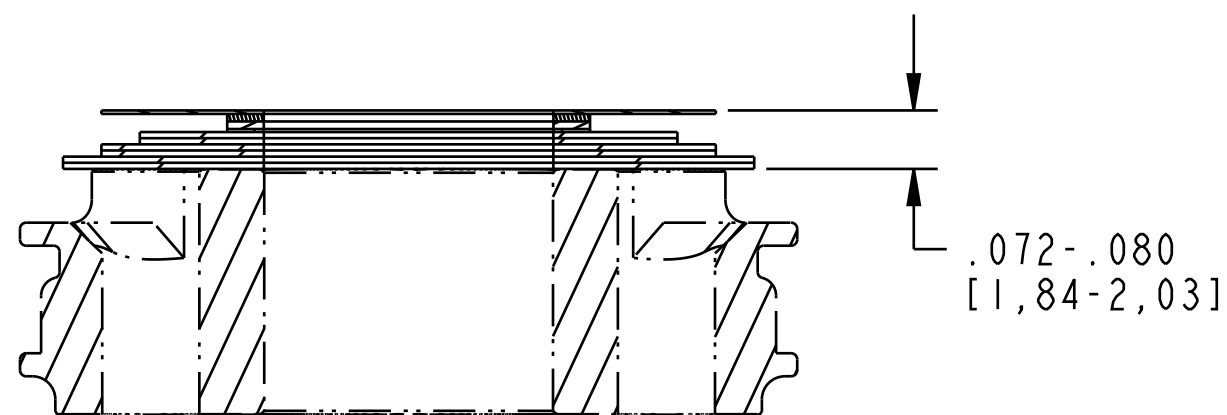

Valve: [.800 OD X .377 ID X .0045 TH]

Valve: Metric [12.0 mm OD X 9.58mm ID X 0.25mm TH]

Valve: Metric [12.0 mm OD X 9.58mm ID X 0.10mm TH]

Valve: [.700 OD X 0.377 ID X 0.008 TH]

Valve: [.800 OD X 0.377 ID X 0.008 TH]

Valve: [.900 OD X 0.377 ID X 0.008 TH]

Valve: Metric [12.0 mm OD X 9.58mm ID X 0.25mm TH]

Valve: [.700 OD X 0.377 ID X 0.008 TH]

Valve: [.800 OD X 0.377 ID X 0.008 TH]

Valve: [.900 OD X 0.377 ID X 0.008 TH]

MAIN PISTON ASSY [1]

NOTES: UNLESS OTHERWISE SPECIFIED

[1] MAIN PISTON ASSEMBLY SHOWN FOR ORIENTATION PURPOSES. NOTE PROPER ORIENTATION OF PISTON--SEE VALVING ASSEMBLY DRAWING FOR DETAILS. IMAGE SHOWN MAY NOT REPRESENT ACTUAL PART GEOMETRY.

[2] ONE SPACER MAY BE ADDED OR REMOVED TO ADJUST NUMBER OF REBOUND CLICKS.

- PROPRIETARY -
THIS DOCUMENT CONTAINS CONFIDENTIAL, PROPRIETARY INFORMATION THAT IS FOX PROPERTY. DO NOT DISCLOSE TO OR DUPLICATE FOR OTHERS EXCEPT AS AUTHORIZED BY FOX.

FOX		FOX Factory, Inc.	Ph 831-768-1100 Fax 831-768-9312
TITLE		130 Hangar Way, Watsonville, CA 95076 USA	
Valve Stack Assy: 2022 FLOAT X & DHX, Rebound, RM			
SIZE	DWG. NO.	805-05-505-KIT	
PLOT SCALE	2:1	SHEET 1 OF 1	

4

3

2

ProE ASSEM