

4

3

2

1

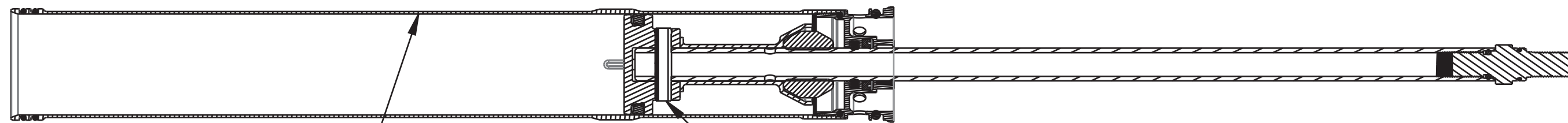

GREASE:
THIN LAYER OF SLICK
HONEY ON SLEEVE ID

IMPORTANT:
ORIENT GAP IN PINS TOWARDS
BASE STUD $\pm 15^\circ$

Seals: O-Ring [8.0MM ID x 1.0MM CS] Metric, N-70, Static

Base Stud: Float, 0.305-48 Thread

Seals: O-Ring [6.0mm ID x 1.5mm CS] Metric, N-70, Static

Topout Spacer, Aluminum, Float NA2, 2021 38

PISTON SEAL

AIR PISTON

Pin: Spring [Ø 0.188 X 0.875 TLG] Spring Steel, Zinc

IMPORTANT:
VERIFY SEAL IS NOT
TWISTED AFTER INSTALL

GREASE:
1 GRAM (MEDIUM LAYER)
OF SLICK HONEY

IMPORTANT:
PRESS PIN
UNTIL CENTERED

LOCTITE:
1-2 DROPS
RED 263

TORQUE:
50 \pm 5 IN-LB

TORQUE:
40 \pm 5 IN-LB

GREASE:
THIN LAYER
OF SLICK HONEY

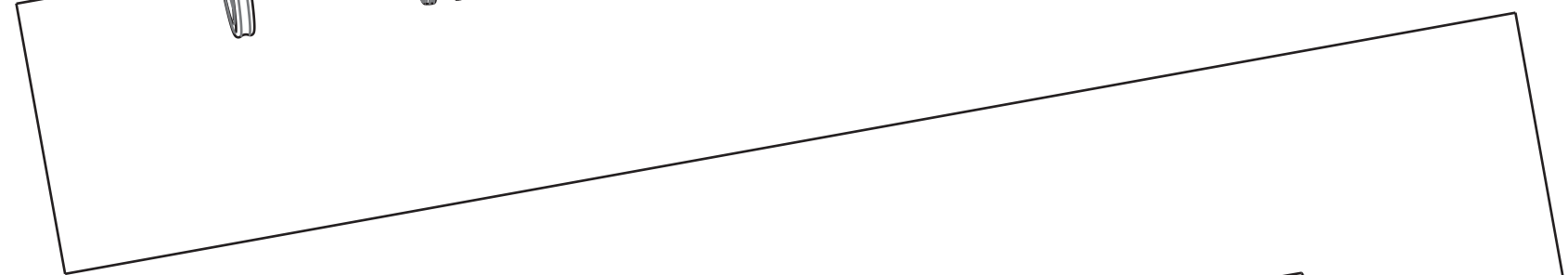

AIR SHAFT

GREASE:
THIN LAYER OF SLICK HONEY
TO ENTIRE LENGTH OF AIR SHAFT

Topout Bumper, 2021 38

820-02-567-KIT
Neg Plate Assy, 2021 38, Inner Air Sleeve, 1.214 Bore

GREASE:
THIN LAYER
OF SLICK HONEY

LOCTITE:
2-3 DROPS
RED 263

INNER AIR SLEEVE

Seals: O-Ring [31.0MM ID x 1.5MM CS] Metric, N-70, Static

Seals: O-Ring [31.0MM ID x 1.5MM CS] Metric, N-70, Static

FOX **FOX Factory, Inc.** Ph 831-768-1100
130 Hangar Way, Watsonville, CA 95076 USA Fax 831-768-9312

TITLE
**2021 38 FLOAT NA2
AIR SHAFT ASSEMBLIES**

SIZE DWG. NO.

C

PLOT SCALE NONE

SHEET 1 OF 1

PROPRIETARY
THIS DOCUMENT CONTAINS CONFIDENTIAL, PROPRIETARY INFORMATION
THAT IS FOX PROPERTY. DO NOT DISCLOSE TO OR DUPLICATE
FOR OTHERS EXCEPT AS AUTHORIZED BY FOX.

4

3

2

1

ProE ASSEM