

4

3

2

1

Retaining Ring: Wire [1.280 OD X .024 CS] SS

Compression Adjust Coupler, F-S, FIT4

ASSEMBLE AT THIS LEVEL

820-05-577-KIT  
2020 34 FIT4 F-S Topcap Assy, Black Ano

TORQUE:  
55±5 IN LBS

820-03-604-KIT  
2020 34 ALL Non-SC FIT4 8mm Damper Shaft Assy

TORQUE:  
55±5 IN LBS

820-03-683-KIT  
2022 32 and 34 Non-SC FIT4 8mm, Bladder Assy, 140 MAX

Seals: O-Ring [3.0MM ID x 1.5MM CS] Metric, N-70, Static

Spring: Detent [.138 TLG, .087 OD, 48 lb/in]

Ball [Ø.1094]

GREASE:  
THIN LAYER OF  
SLICK HONEY ON BALL

ASSEMBLE THESE PARTS AFTER OIL FILL

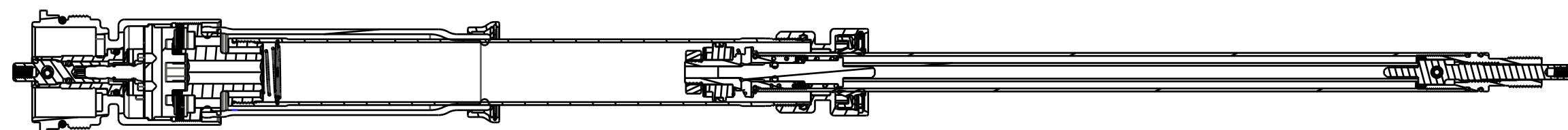

SECTION A-A  
SCALE 0.750

PROPRIETARY  
THIS DOCUMENT CONTAINS CONFIDENTIAL, PROPRIETARY INFORMATION  
THAT IS FOX PROPERTY. DO NOT DISCLOSE TO OR DUPLICATE  
FOR OTHERS EXCEPT AS AUTHORIZED BY FOX.

**FOX** **FOX Factory, Inc.**  
130 Hangar Way, Watsonville, CA 95076 USA  
Ph 831-768-1100  
Fax 831-768-9312

TITLE  
**2022 34 NON-SC FIT4 F-S 3 POS ADJ  
CARTRIDGE ASSEMBLIES**

SIZE DWG. NO.  
**C**  
PLOT SCALE 1.0:1 SHEET 1 OF 1

4

3

2

1