

4

3

2

1

Retaining Ring: Wire [1.280 OD X .024 CS] SS

Compression Adjust Coupler, F-S, FIT4

ASSEMBLE AT THIS LEVEL

820-05-581-KIT
2020 34 FIT4 F-S Topcap Assy, CL Tune, Black Ano

TORQUE:
55±5 IN LBS

820-03-604-KIT
2020 34 ALL Non-SC FIT4 8mm Damper Shaft Assy

TORQUE:
55±5 IN LBS

820-03-683-KIT
2022 32 and 34 Non-SC FIT4 8mm, Bladder Assy, 140 MAX

Seals: O-Ring [3.0MM ID x 1.5MM CS] Metric, N-70, Static

Spring: Detent [.138 TLG, .087 OD, 48 lb/in]

Ball [Ø.1094]

GREASE:
THIN LAYER OF
SLICK HONEY ON BALL

ASSEMBLE THESE PARTS AFTER OIL FILL

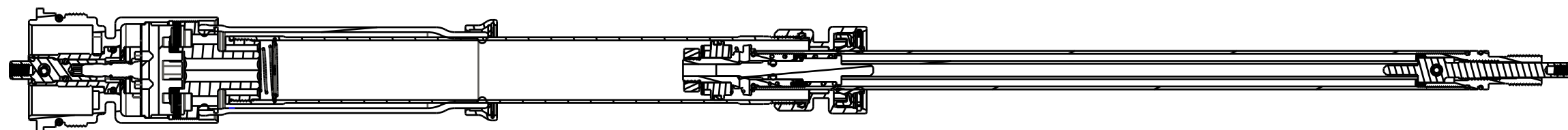

SECTION A-A
SCALE 0.750

PROPRIETARY
THIS DOCUMENT CONTAINS CONFIDENTIAL, PROPRIETARY INFORMATION
THAT IS FOX PROPERTY. DO NOT DISCLOSE TO OR DUPLICATE
FOR OTHERS EXCEPT AS AUTHORIZED BY FOX.

FOX FOX Factory, Inc. Ph 831-768-1100
130 Hangar Way, Watsonville, CA 95076 USA Fax 831-768-9312

TITLE
2022 34, 140 MAX, FIT4 F-S,
CL Tune, 3 Pos Adj Cart Assy

SIZE DWG. NO.

C

PLOT SCALE 1.0:1

SHEET 1 OF 1

ProE ASSEM

4

3

2

1