

4

3

2

1

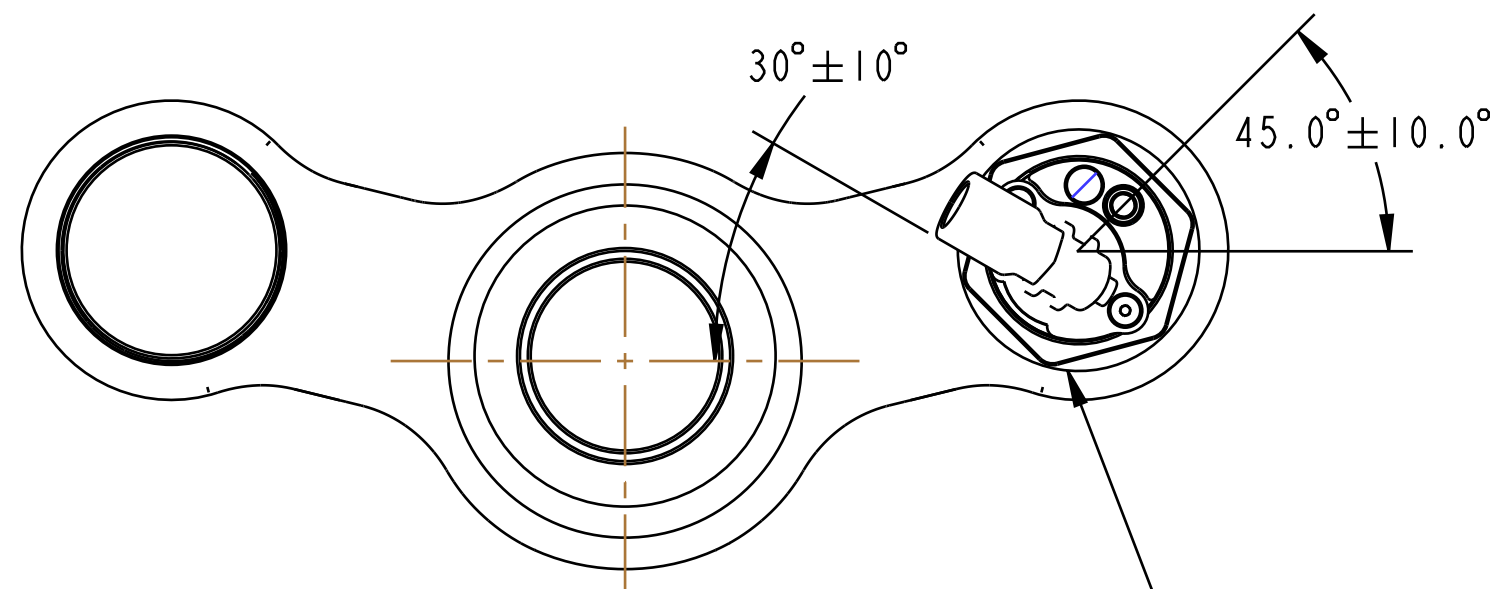

IMPORTANT:
AFTER TOPCAP IS TORQUED,
ALIGN ADJUSTER AND CAP AT ANGLES SHOWN

REFERENCE ONLY
(FOR INSTALLATION
INTO FORK)

TORQUE:
50 ± 5 IN. LB FOR 10mm HEX
80 ± 5 IN. LB FOR 15mm HEX

Screw

LOCTITE:
BLUE 242
ONE DROP

TORQUE:
5 ± 1 IN. LB.

REBOUND KNOB

BOTTOM NUT

CRUSH WASHER

DAMPER BOTTOM STUD INTERFACE PARTS:
(Parts pictured above may not look exactly like the parts listed below. Only one set is pictured for reference)

- 820-05-228-KIT: 2017 FIT4 Bottom Stud Interface Parts, 32, SC, 29in Fork
- 820-05-377-KIT: 2016 FIT4 Bottom Stud Interface Parts 36, 38 and 40
- 820-05-335-KIT: 2016 FIT4 Bottom Stud Interface Parts 34
- 820-05-506-KIT: 2019 34 SC Bottom Stud Interface Parts, 29in Fork

TORQUE:
220 ± 5 IN LB
INTO FORK

010-01-003
Ball [Ø 0.1875] Delrin

CARTRIDGE ASSY

- PROPRIETARY -
THIS DOCUMENT CONTAINS CONFIDENTIAL, PROPRIETARY INFORMATION
THAT IS FOX PROPERTY. DO NOT DISCLOSE TO OR DUPLICATE
FOR OTHERS EXCEPT AS AUTHORIZED BY FOX.

| | | | |
|---|----------|---|------------------|
| | | FOX Factory, Inc. | Ph 831-768-1100 |
| | | 130 Hangar Way, Watsonville, CA 95076 USA | Fax 831-768-9312 |
| TITLE 2021 LIVE Complete Cartride Assemblies | | | |
| SIZE | DWG. NO. | | |
| C | | | |
| PLOT SCALE | NONE | SHEET 1 OF 1 | |