

4

3

2

1

D

D

C

C

B

B

A

A

210-24-034  
Compression Piston Clamp, FIT4, Lightweight

045-00-150  
Valve: Metric [15mm OD X 8mm ID X .15mm]

039-00-205  
Spring, Comp. Check

040-12-060  
Valve: [.600 OD X 0.377 ID X 0.012 TH]

038-00-142  
Retaining Ring: Snap, Smalley, Internal, VH-62 , Ø.610 Bore



! IMPORTANT:  
THIN VALVE FACES  
COMPRESSION CLAMP

! IMPORTANT:  
SMALL DIAMETER OF SPRING  
FACES COMPRESSION CLAMP

! IMPORTANT:  
THICKER VALVE FACES  
RETAINING RING

OIL:  
THIN LAYER OF FOX MX5 DAMPER OIL

! IMPORTANT:  
ENSURE RETAINING RING  
FULLY SEATED FULL 360 DEG

207-11-131  
Pressure Tube, [15.5mm Ø X 170mm TLG] LIVE Lightweight 32 26/27.5/29 80-100

210-22-303  
Bladder, 010 RL\_RLC

210-22-420  
Lower Bladder Ring, Snap Ring, 011 RC2

241-01-029  
Bladder retainer, 011 RC2

038-00-065  
Retaining Ring: Snap, Smalley, Internal, Custom, Ø.923 BORE

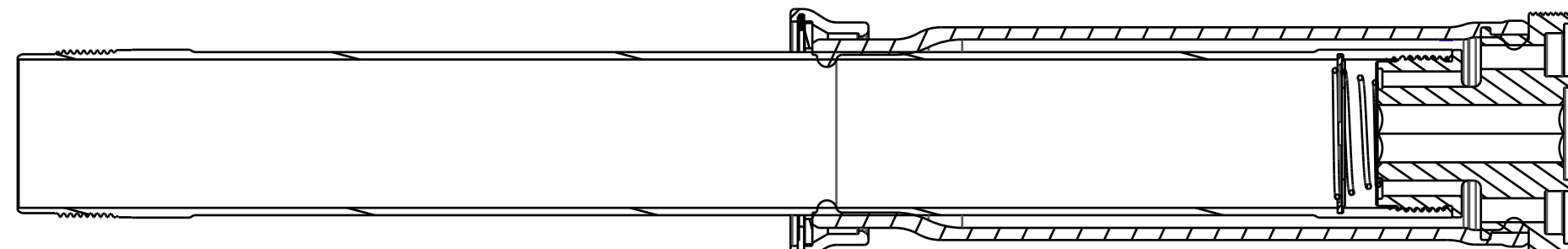

- PROPRIETARY -  
THIS DOCUMENT CONTAINS CONFIDENTIAL, PROPRIETARY INFORMATION  
THAT IS FOX PROPERTY. DO NOT DISCLOSE TO OR DUPLICATE  
FOR OTHERS EXCEPT AS AUTHORIZED BY FOX.

**FOX** FOX Factory, Inc. Ph 831-768-1100  
130 Hangar Way, Watsonville, CA 95076 USA Fax 831-768-9312

TITLE 2019 34 SC 27.5in and 29in  
120 Max FIT4, Bladder Assy

SIZE DWG. NO. C 820-03-565-KIT

PLOT SCALE | .50 : 1 | SHEET | OF | 1

4

3

2

1

ProE ASSEM