

4

3

2

1

210-24-249
Damping Adj Part: Knob, Comp Selector, 34/36 Grip

039-00-375
Spring: Wave, 4 Turns, [.562 Bpre, .375 Shaft, .260 Height, 37.0 lb/in] SS

210-24-123
Damping Adj Part: Detent, Molded, Grip

(210-24-123)
036-01-044
Seals: U-Cip, Shore 70A, 2013 CTD-ADJ, Remote O/C-CTD

GREASE:
THIN LAYER
OF SLICK HONEY

TORQUE:
4±1 in-lb

820-05-454-KIT
2018 Grip P-S Topcap Interface Parts

820-05-518-KIT
2019 36 Grip Bottom Stud Interface Parts

241-01-011
Fastener, Custom: Crush Washer, Plastic, 13mm

241-00-022
Fastener, Custom: Nut, Bottom, 011

210-03-178
Knob, Rebound, 2-Stroke, Knurled, M10 Nut

TORQUE:
5.0±0.5 IN.LB.

LOCTITE:
BLUE 242 OR 243
ONE DROP

TORQUE:
150±7
(IN-LB)

018-01-004-A
Fastener, Standard: Screw [#8-32 X 0.250 TLG]
303 SS, Socket Set Half Dog Point

REFERENCE ONLY
(FOR INSTALLATION
INTO FORK)

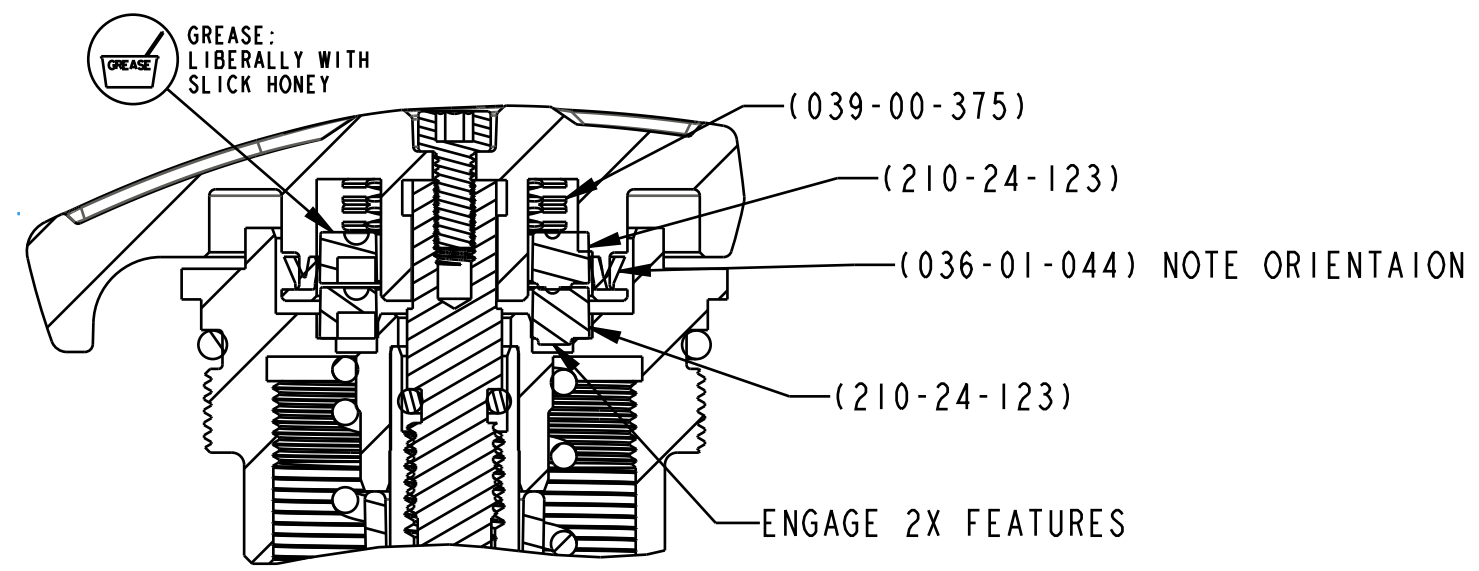

SECTION A-A
SCALE 2.500

FOX **FOX Factory, Inc.** Ph 831-768-1100
 130 Hangar Way, Watsonville, CA 95076 USA Fax 831-768-9312

TITLE **2019 36mm 180 MAX P-S Grip Cartridge Assemblies Complete**

SIZE DWG. NO. **C**

PLOT SCALE 0.75:1 SHEET 1 OF 2

PROPRIETARY - THIS DOCUMENT CONTAINS CONFIDENTIAL, PROPRIETARY INFORMATION THAT IS FOX PROPERTY. DO NOT DISCLOSE TO OR DUPLICATE FOR OTHERS EXCEPT AS AUTHORIZED BY FOX.